



411 ADA Studio

Built to Standards. Ready to Live.



ABOUT THE 411ADA STUDIO

This 1-bedroom, 1-bathroom unit combines durable construction and modern functionality, designed per IBC 2021 Building Code with a heavy-duty galvanized steel frame, bolted exterior walls, and energy-efficient insulation. Engineered for accessibility, it includes a steel entry ramp, larger doors, and an accessible toilet and shower with a rain shower head. The modern kitchen features quartz countertops, a double sink, LED lighting, and is pre-wired for a 20" stove, while the laundry closet is plumbed for a convenient washer and dryer setup. Additional highlights include 2mm PVC flooring, insulated plumbing, designated breaker for HVAC, and a 100-amp electrical feed, ensuring both practicality and comfort in its design.

FEATURES



1 Bedroom



1 Bathroom



Laundry



by MOD BOX



pictured with optional porch, roof, and carport



411 ADA Studio

GENERAL SPECIFICATIONS

info@UnboundNest.com

- 1 bedroom/1 bath/ laundry closet
- Shipping dimensions 88" x 235" x 99"H

- Set up exterior dimensions 243" x 235" x 99"H
- Set up interior dimensions 236" x 225" x 88.5"

BUILDING SPECIFICATIONS

- 2" of spray polyurethane foam insulation in floor
- 2.89" of EPS insulation in walls and ceiling
- Decorative steel cladding on outside walls for additional insulation
- Double-paned energy-efficient doors and windows
- Large glass entry door
- Corrugated steel roof

- Built-in system to anchor to concrete
- External walls and roof are metal-to-metal construction
- 2mm thick PVC flooring
- Electrical wiring that meets IBC code
- Designated breaker for a mini split HVAC system
- All copper wires (no aluminum)
- 100 amp feed
- Exterior lights and GFCI plugs at front door

ADDITIONAL INFORMATION

FLOOR PLAN

- Kitchen is pre-wired for 20" stove
- Quartz stone countertops
- Double kitchen sink
- High efficiency LED lighting
- Installed on-demand water heater
- Rain shower head with handheld shower wand
- Full size bathroom sink
- Accessible full size toilet
- Accessible shower
- Larger doors
- MGO cement floorboards
- Complete with steel entry ramp and rails
- Insulated PEX pipes for plumbing

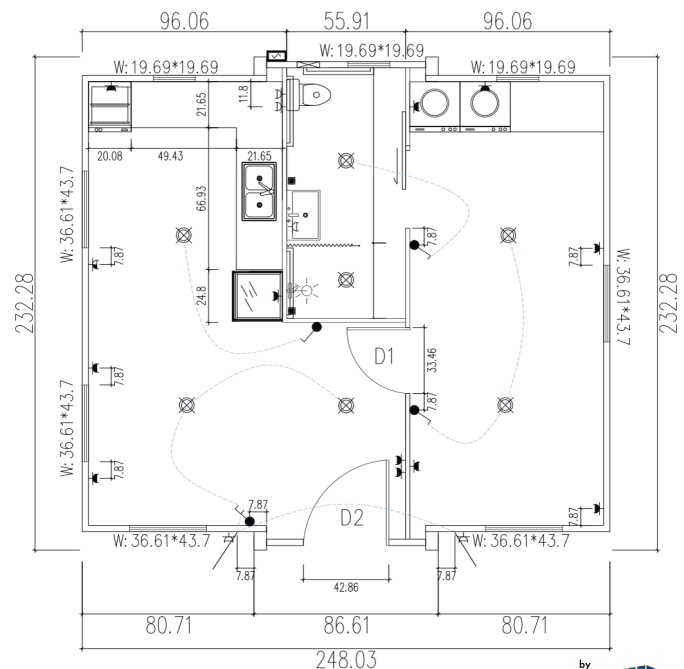

by
MOD BOX